



**Premier  
Properties**  
Perth



## 9f Foundry Lane, Perth, PH1 5PR Offers Over £69,950

 1  1  1  C

The property comprises a spacious lounge that boasts ample natural light, creating a warm and inviting atmosphere, the large lounge is perfect for both relaxation and entertaining and features a lovely Juliette balcony, there is a well-proportioned bedroom, providing a peaceful retreat. The bathroom is bright and spacious, the kitchen provides ample storage completing the home.

With on-street parking available, this property is ideal for those who require easy access to their vehicle while enjoying the benefits of city living. The location is superb, placing you within walking distance of local amenities, shops, and eateries, making it a perfect choice for anyone looking to immerse themselves in the lively atmosphere of Perth.

This flat is an excellent opportunity for first-time buyers, buy to let, or those seeking a convenient city base. Do not miss the chance to make this delightful property your new home.

- 1 bed flat
- On-street parking available
- Located in city centre
- Close to amenities
- Easy access to transport
- Viewing recommended



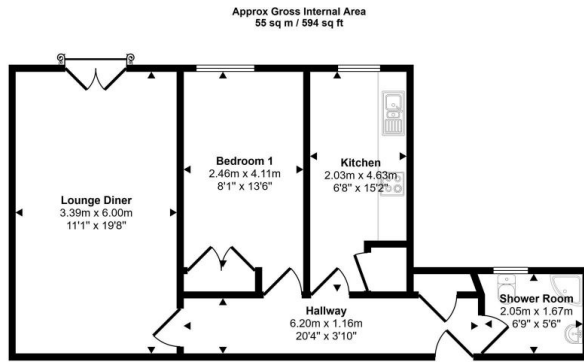

Floorplan

This floorplan is only for illustrative purposes and is not to scale. Measurements of rooms, doors, windows, and any items are approximate and no responsibility is taken for any error, omission or mis-statement. Icons of items such as bathroom suites are representations only and may not look like the real items. Made with Made Snappy 360.

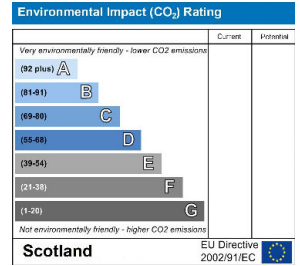
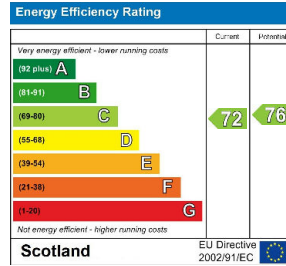

These particulars, whilst believed to be accurate are set out as a general outline only for guidance and do not constitute any part of an offer or contract. Intending purchasers should not rely on them as statements of representation of fact, but must satisfy themselves by inspection or otherwise as to their accuracy. No person in this firm's employment has the authority to make or give any representation or warranty in respect of the property.